

Wednesday

September 1, 1971

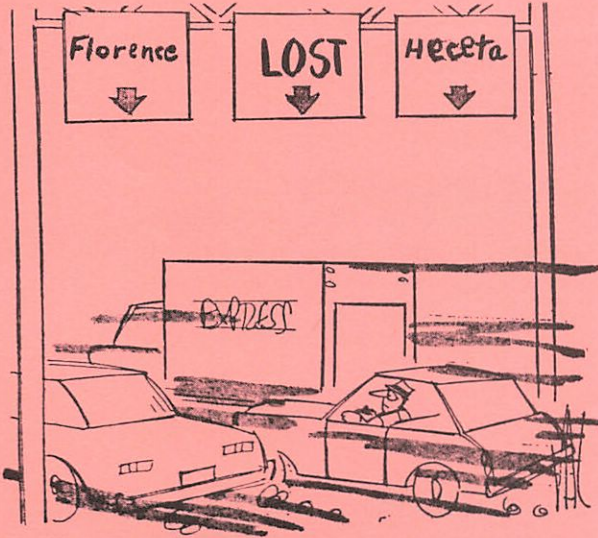

THINGS ARE PRETTY QUIET in the administration building. Administrators left early Tuesday morning for a two-day workshop at Heceta House.

Among the items scheduled for discussion are the budget, the college's organizational structure, long-range facility planning, and enrollment

DECISION ON BUDGET TO BE MADE SEPT. 8:

The LCC Board will decide at its Sept. 8 meeting whether to call a fourth budget election.

Dr. Schafer has estimated that the Aug. 26 election defeat could possibly mean denying admission to 2,000 to 3,000 of the nearly 20,000 individual students who are expected to want to attend LCC full or part-time this year.

The president said last week he may recommend to the Board that a fourth election be held, seeking an amount of extra property taxes that will not raise the college's overall 1970-71 property tax rate of \$1.52. He estimated an extra \$400,000 to \$500,000 could be raised within that tax rate.

Without the added taxes, Dr. Schafer has said, LCC may have to turn away as many as 5,000 individual students.

A CLOSER LOOK AT THE VOTES

ELECTION RUNDOWN

(comparing results of June 29 and Aug. 26 elections)

TOTAL VOTE

June 29: No - 10,488
Yes - 8,295
18,783

Aug. 26: No - 12,346
Yes - 7,783
20,129

	June 29		Aug. 26	
	YES	NO	YES	NO
EUGENE	5730	5794	4265	5433
SPRINGFIELD	1092	1966	1502	2906
COTTAGE GROVE	253	487	635	899
JUNCTION CITY	183	256	242	580
FLORENCE	109	170	197	365
FERN RIDGE	65	260	130	441
CRESWELL	85	195	143	377
PLEASANT HILL	121	195	150	219
OAKRIDGE	102	177	158	240
HARRISBURG	41	26	43	14
MONROE	9	12	13	11
MAPLETON	59	63	59	148
MCKENZIE	41	84	35	96
LOWELL	31	60	75	216
MARCOLA	20	38	51	153
BLANCHLY	14	40	18	72

TEMPORARY OPENING: Secretary II for
Oct.-Dec. Language Arts Dept.
Apply to John Howard, chairman.

THE INSTRUCTIONAL COUNCIL will NOT
meet this week. The next meeting
will be Sept. 16 at 3 p.m. in
the Board Room.

THE HOME ECONOMICS DEPT. office is
now located in the former
Veterans Counseling facilities,
lower level of the Health & P.E.
building.

TEMPORARILY, the department
may be reached at Ext. 261 or 262.

BABY SHOWER PLANNED:

Friends of Cheryl Matecki,
Language Arts secretary, are invited
to a baby shower in her honor, Friday
at 12 noon in the staff lounge.

HOUSE FOR RENT: Small, furnished,
one bedroom house for couple or
single person. Springfield.

Contact A. J. McNeese, Ext. 365
Maintenance, or 747-9425.

FOR SALE: Honda 175 CC Road Bike.
\$450 cash. Contact Jerry Sirois,
mailroom.

School suspense story

One of these years — as long as it holds to
the current system of financing its schools —
Oregon is going to have an education crisis. It
could be a big one, as seems to be looming in
Portland and some other populous districts; or
it could be a small one, as in the Denny Element-
ary District in Linn County, which last week
finally passed its budget, 33 to 12.

But it seems inevitable that some school
doors will have to close before a change in
school financing can win popular approval. As
long as school costs must be paid disproportion-
ately from the local property tax, the threat of
school closure for lack of funds will persist.

Most districts without a budget among the
eight administering elementary and secondary
schools and the one (Lane) operating a com-
munity college have more serious problems
than does Portland District No. 1. Local authori-
ties say that the school year must be shortened
several days in May, if the special levy sched-
uled in late September is not approved. But in
the South Lane County District, No. 45J, the vot-
ers last week turned down a \$2 million special
levy amounting to well over half the \$3.4 million
1971-72 budget. The prospect for school closure
by Christmas is real in South Lane County.

Creswell votes today, Rainier on Wednesday
on critical special levies. Later in September, in
addition to Portland, school budget approval
will be sought for the third or fourth time in
Medford, Silverton, Brookings-Harbor, and
Phoenix. South Lane, too, will be forced to re-
submit its budget.

It's a suspenseful way to run a school sys-
tem.

--From OREGONIAN editorial page.

Aug. 31, 1971

Submit items for the Daily
to Kathy Dave, ext. 340, or
second floor Admin.

Wednesday

September 8, 1971

REVIEW OF THE 1971-72 BUDGET is the major item on the agenda for tonight's Board of Education meeting, which is to begin at 7:30 in the Board room. Administrators worked nights and into last weekend to come up with some options for Board consideration. They came down to two:

1. Operate within the \$1,685,000 tax base plus a \$240,000 Emergency Employment Act grant which we're now expecting to receive under President Nixon's pump-priming program. The EEA money would pay salaries of 19 instructors. Along with the base, it would make it possible to serve about 4,920 FTE students.

2. Ask voters to approve a levy in the neighborhood of \$500,000 beyond the 6% limitation. An election could be held as early as Tuesday, Sept. 28. This amount would hold the College's tax rate at about the same level as that of the past two years--about \$1.52 per \$1,000 true cash value. A turn down by voters would reduce the levy by about 25¢. Voter approval, plus the EEA grant, would enable the College to serve about 5,600 FTE students.

Should the Board choose the second option, it will be asked to decide whether the opening of College should be delayed a week to Monday, Oct. 4. This would give the registration crew a chance to register additional students if the proposed levy were approved by voters. Fall Term could be extended an additional week into December.

AN ENROLLMENT REPORT by Registrar Bob Marshall will indicate that around 4,737 students already have said they want to register for Fall Term. The total includes about 1,937 new students. Registration for students returning from last Spring Term is Sept. 13-15. New students and those returning from other than Spring Term will register Sept. 20-23.

OTHER AGENDA ITEMS: Approval of \$51,224 in construction claims; canvass of, you should pardon the expression, the Aug. 26 election; adoption of a Board policy on copyrights; discussion of a change in the Oregon Statutes by which compulsory school attendance is dropped to age 16, and its effect on LCC's high school completion program; a resolution to change the maximum purchase allowed without formal bidding from the present \$2,000 to \$5,000; a resolution to change LCC's official designation from "Area Education District" to "Lane Community College District."

PRESIDENT SCHAFER is to be Larry Taylor's guest Thursday at 9 a.m. on the KEZI-TV Coffee-Time News.

NEW ADDRESS: The Educational Coordinating Council has moved to the new IBM building and the new address is 4263 Commercial Street S.E., Salem, OR 97310. The phone number remains the same, 378-3921.

STUDENT MARK PARRISH, co-chairman of LCC's Institutional Bill of Rights Committee, has written to Dr. Schafer to express appreciation to those who assisted in the writing of the Bill of Rights. Said Parrish: "I believe that our work has resulted in an institutional protection of rights and an outlining of responsibilities and conduct which could be used as a model for the entire nation's educational institutions."

THE HOME ECONOMICS department is back on its regular telephone extensions as of this week. The numbers are 208, 209 for the main office and ext. 264 for the Child Care Center. The Department is now housed in the former Veterans' Counseling Center, first floor Health Building.

PRINTING/GRAPHICS has set a new printing record for August. The new record is 1,353,582 impressions.

CHILD CARE OPENINGS: The Child Care Center operated by Springfield School District, 1985 N. 19th Street, is accepting children ages 3-5 beginning Sept. 7. Full day care and educational services are provided. Fees are prorated according to parents' income. To apply call 747-3331, ext. 357.

Thursday

Submit items for the Daily
to Kathy Dave, ext. 340, or
second floor Administration.

September 9, 1971

FOURTH TRY FOR AN operating levy for this school year will be Tuesday, September 28.
Amount: \$493,078. Cost: 27.8¢ per \$1,000 TCV.

This is approximately the same \$1.52 to \$1.55 tax rate which LCC has had since 1968.

Opening of Fall Term classes will be delayed until Monday, October 4. This will provide time to get organized, whichever way the election goes. Time lost will be made up during the term or tacked onto the end. Teachers will get a dead week between In-Service and the opening of school.

The Board of Education agreed to hold another election Wednesday night, pointing out that approval of the September 28 proposal will still shut the admissions door to at least 500 FTE students and maybe more. Associate Dean of Instruction Gerry Rasmussen said that it's impossible to predict accurately at this time what the FTE total will be because it's impossible to know the exact classes in which students will enroll. A guess for the year might be 5,500 FTE.

Almost every class is being studied to determine the enrollment level at which each breaks even financially. Those classes which cannot justify themselves financially are likely to be cancelled.

PROTECTION FOR regular employees is a high priority. Contracted teachers will be assigned class loads first; then part-timers will get the nod if needed.

THAT OTHER 2-1/2% OF the salary package is still up in the air. It's dependent on the unfreezing of the freeze and availability of money. Board members Catherine Lauris and Robert Ackerman made it clear that they favor giving the full salary hike if possible.

SHIRLEY HULEGAARD of Eugene told the Board that she has renewed her last year's request to the Oregon Board of Education that it make a "thorough investigation of the Board and Administration of LCC. Her request apparently is based on an anonymous letter from four disgruntled LCC employees.

Board member Ackerman chided Mrs. Hulegaard for bringing anonymous accusations without being willing to identify those who make them. He said the letter's charges "seem unfounded." Chairwoman Lauris said the Board is "not going to pursue this without evidence." The subject was dropped shortly after student Mark Parrish urged the Board to "not worry about this kind of crap."

LCC WILL HOST the OCCA Classified workshop this year for all Oregon community colleges. Any classified staffer with ideas for the work session are asked to contact Sammy Wilbanks, Social Science; Judy Piercy, Office of Instruction; or Martin McMaster, College Facilities.

TOM KEPNER, assistant professor of communication skills, left last week to join the staff of United States International University.

Submit items for the Daily to
Kathy Dave, Ext. 340, or second
floor Administration.

Friday

September 10, 1971

STAFF IN-SERVICE starts Monday and runs through Sept. 24. Monday's schedule:

8 a.m. - Breakfast and Orientation for New Staff only - Center 124.

10 a.m. - General meeting of all staff - Forum 301.

Speakers: President Schafer, ASB President Omar Barbarossa

In-Service will be outlined.

1 p.m. - Departmental Meetings.

STEVE JOHN, science prof, is chairman of the Professional Growth Committee, which has organized the In-Service.

THE RECENT EVALUATION of classified personnel by Gary Miller was done at no expense to LCC. The study cost \$1,000, which was paid by the Oregon Board of Education.

OPEN ENROLLMENT IN SEPTEMBER: The Greater Oregon Health Service has approved the entire month of September for enrollment of employees' dependents for the college health plan. Any employees who wish to enroll dependents can do so this month, with coverage available Oct. 1, 1971.

NOTE FROM AUDIO-VISUAL SERVICES: All instructors who have ordered films for Fall Term, please contact Audio-Visual Services, ext. 251, and tell us what arrangements to make concerning your film schedule with regard to the one week delay in beginning classes.

IT'S OFFICIAL: Board members approved a "new" name for LCC at the Wednesday night meeting. We are now the Lane Community College District, rather than the Area Education District.

PART-TIME POSITION: Part-time Clerk II position in the Child Development Center. Contact Jill Heilpern, supervisor, for details.

PERMANENT STAFF PARKING decals are available in the security office, first floor Administration. All staffers are required to display the decals in the left rear window of their motor vehicles. Please come prepared with your car license number and car make. These registration stickers should be picked up no later than Sept. 24.

SENATOR EDMUND MUSKIE's scheduled Thursday visit to an LCC basic education class did not take place. It was cancelled due to his late arrival to Eugene.

LCC WILL HOST the Oct. 14 initial meeting of the new Council on State System-Community College Relations. President Schafer was a member of the committee which developed plans for the Council, which will be charged with assuring cooperation and coordination between Oregon's two higher education groups.

CONCERNED ABOUT AIR POLLUTION? Have your car tested for exhaust emission and help conserve our air. The Lane Regional Air Pollution Authority and the Sun Electric Corporation are sponsoring the exhaust emission tests at Autzen Stadium parking lot today and tomorrow from 9 a.m. to 5 p.m.

CHANGING TIMES: The Chronicle of Higher Education reports that the National Student Association has established a "Gay Desk" with one salaried position to coordinate the activities of the homosexual liberation movement on various campuses.

JOE MALIK, who was an administrative intern at LCC four years ago, is now vice president for instructional services at Grossmont College, El Cajon, Calif.



FOR SALE: 1967 Datson, four-door sedan, 50,000 miles--TOP SHAPE-- \$900.00. Call 343-9813.



LARRY MURRAY, Special Training Programs director, has been ill. Some of his staff sent him this memo yesterday:

We noticed on Wednesday that you were out of your office a little more than usual. We checked with Eldon who reported you were suffering from other than the usual ailment and by a vote of 3 to 2 the staff decided to send a get well card; however, no one would contribute funds; therefore, we are sending this document in lieu of said card.

We polled the administration and they abstained from expressing a completely black or white opinion on this type of issue.

Submit items for the Daily to
Kathy Dave, Ext. 340, or second
floor Administration.

Monday

September 13, 1971

WELCOME, YOU 221 CONTRACTED STAFF MEMBERS!

Two of you are new (replacements rather than additions);

- Susan Cooley in Health and Physical Education;
- Ralph Peterson in Journalism.

Three are familiar faces in new roles:

- Ken Hills, back from the Oregon Board of Education to his old job as director of counseling;
- Karla Schultz, from part-time to full-time language arts professor;
- Phil Robley, from printing/graphics to audio-visual services coordinator.

TWO WEEKS OF IN-SERVICE started today, but not with the originally scheduled breakfast for new people. It was cancelled due to the small number of potential participants. Perhaps somebody will buy Susan and Ralph a welcoming cup of coffee this morning.

TODAY

10 a.m. General Meeting of All Staff in Forum 301
Speakers: President Schafer, ASB President Omar Barbarossa.
In-Service will be outlined.

1 p.m. Departmental Meetings

TUESDAY

9 a.m. Departmental Activities or Individual Preparation Time

1 p.m. General Meeting of All Staff in Forum 301
Speaker: Dean Case
Report from Staff Personnel Policies Committee

3 p.m. Staff Association Section Meetings
Faculty in Forum 309
Classified in Forum 311

BACK ON REGULAR 8 a.m. to 5 p.m. schedules today are many members of the secretarial corps who have taken shortened lunch hours, or arrived earlier so that they could leave earlier to take advantage of the summer evenings.

TRYOUTS WILL BE HELD TONIGHT for a new children's theatre repertory company, at 7:30 in the basement of the Center Building next to Performing Arts Offices. Contact Lou Salerni at Ext. 318. Anyone interested in any facet of this activity is welcome.

THE COLLEGE CABINET SEPTEMBER 14 MEETING IS CANCELLED because of In-Service activities. The next meeting is scheduled for September 21 at 3 p.m.

PERMANENT STAFF PARKING decals are available in the security office, first floor Administration. All staffers are required to display the decals in the left rear window of their motor vehicles. Please come prepared with your car license number and car make. These registration stickers should be picked up no later than September 24.

OPEN ENROLLMENT IN SEPTEMBER: The Greater Oregon Health Service has approved the entire month of September for enrollment of employees' dependents for the college health plan. Any employees who wish to enroll dependents can do so this month, with coverage available October 1, 1971. (Employees whose dependents were covered under the former health plan with Equitable were automatically enrolled by transfer of coverage).

NOTE FROM AUDIO-VISUAL SERVICES: All instructors who have ordered films for Fall Term, please contact Audio-Visual Services, ext. 251, and tell us what arrangements to make concerning your film schedule with regard to the one week delay in beginning classes.

THE CHILD DEVELOPMENT CENTER at the Unitarian Church, 40th and Donald has need of:

- chest of drawers or bookcase
- cupboard (with doors) for storing dishes

If you can provide either of these, please contact the Child Development Center directly, or 264 on our campus.

JILL HEILPERN, coordinator of the Child Development Center is in Sacred Heart Hospital recovering from major surgery. She hopes to be released from the hospital by Wednesday, September 15.

FINALISTS FOR THE APPOINTMENT TO THE LCC BOARD OF EDUCATION position are KEN KESEY of Pleasant Hill and STEPHEN REID of Fall Creek. Kesey is an author-farmer; Reid is a self-employed logger-rancher. A decision may be made at the October 6 Board meeting.

PART-TIME POSITION: Part-time Clerk II position in the Child Development Center. Contact Jill Heilpern, supervisor, for details.

FOR SALE: 1967 Datson, four-door sedan, 50,000 miles -- top shape -- \$900.00. Call 343-9813.

Submit items for the Daily to
Kathy Dave, Ext. 340, or
second floor Administration.

Tuesday

September 14, 1971

STAFF IN-SERVICE continues with the following schedule:

TODAY

- 9 a.m. Departmental Activities or Individual Preparation Time
- 1 p.m. General Meeting of All Staff in Forum 301
Speaker: Dean Case
Report from Staff Personnel Policies Committee
- 3 p.m. Staff Association Section Meetings
Faculty Section with Budget officers Forum 309
Classified Section in Forum 311

WEDNESDAY

- 9 a.m. College Committees Meet: Academic Council in Cen 402, College Store Commission in Cen 403, Convocations and Public Events in Cen 404, Instructional Support in Cen 406, Insurance in Apr 211, Media Board in Cen 405, Professional Growth in Apr 213, Public Relations in Cen 422, Social in Apr 212.
- 10:30 a.m. Campus Tours - Individual Preparation Time
- 1 p.m. Individual Preparation Time
- 1:30 p.m. Campus Tours
- 4 p.m. Information about the Insurance Fringe Benefits, Apr 223

CAMPUS TOURS will be conducted for staff tomorrow at 10:30 a.m. and 1:30 p.m. The tours will require over an hour and include about a mile of walking. If interested, tell Gina Ing at Ext. 332.

MORE THAN 800 students returning from Spring Term registered yesterday, reports Registrar Bob Marshall. By close of returning-student registration Wednesday, about 2,500 will have registered. Registration is proceeding smoothly, largely without the very long lines of the past, because students have been scheduled to appear by appointment. A comparative hush prevails in the gym, in contrast to the survival-of-the-fittest roar of the past.

ON CAMPUS TODAY to construct booths for the manipulative portion of the State Electrical Apprenticeship Contest are some 8 corpsmen and an instructor from the carpentry program at the Wolf Creek Jobs Corps Center at Glide. The electrical contest will be held Saturday in the LCC Apprenticeship Building. The 10 top graduates from 4-year apprenticeship programs will compete for skills recognition and trophies. Joint sponsors are the National Electrical Contractors Association and the International Brotherhood of Electrical Workers.

SUGGESTIONS FOR making up the week lost between In-Service and the beginning of classes have included these from the Instructional Council:

- ... Extend the class periods to 55 minutes in order to complete the 12-week term in the shorter 11-week time
- ... Teach on holidays (there are two, three-day holidays within this period)
- ... Hold Saturday classes
- ... Teach through December 24
- ... No final exam week
- ... Additional student conferences
- ... Individualized instruction
- ... Evening seminars

A SCHOLARSHIP fund for teacher training has been established in memory of OBE associate superintendent Dr. Joy Hills Gubser, who died Sept. 8. The family has asked that contributions be made to the fund in lieu of flowers. Contributions should be made out to the Joy Hills Gubser Scholarship Fund and sent to John Taylor, Oregon Board of Education coordinator of handicapped children.

THE BUS SERVICE from downtown Eugene to the campus is back on schedule after a temporary break in service yesterday. The regular runs begin at 7:30 a.m. in downtown Eugene and continue daily until 5 p.m. when the bus leaves the campus for its last run to Eugene.

ALL FOOD SERVICE facilities will close at 1 p.m. Friday, Sept. 17 to allow workmen to seal the brick floors in the dining areas. The Snack Bar will resume service Monday, Sept. 18, with full Food Service operations reopening for Fall Term on Monday, Oct. 4 with the beginning of classes.

JOHN PHILLIPS, forestry prof, is in Stockholm, Sweden today at the World Conference of Forestry Education. His trip will also include touring lumber operations in Oslo, Norway. He will be back on campus Oct. 8.

ON THE SICK LIST: We have three staffers now recuperating at home following various hospital visits. Dr. Florence Goulding, Health & P.E. prof, Ginny DeChaine, Mass Communications Dept. chairman, and Larry Murray, director of Special Training Programs.

WANTED: Male Siamese for stud; terms to be arranged, contact Bob Boettcher, science prof, Ext. 382, or 688-6575.

FOR SALE: 1969 VW with sunroof, 30,000 miles--GREAT SHAPE--\$1400. Call 344-6150 evenings or weekends.

Submit items for the Daily to
Kathy Dave, Ext. 340 or second
floor Administration.

Wednesday

September 15, 1971

IN-SERVICE SCHEDULE FOR:

Today

9 a.m. College Committees Meet: Academic Council in Cen 402, College Store Commission in Cen 403, Convocations and Public Events in Cen 404, Instructional Support in Cen 406, Insurance in Apr 211, Media Board in Cen 405, Professional Growth in Apr 213, Public Relations in Cen 422, Social in Apr 212, Curriculum, Board room.

10:30 a.m. Campus Tours - Individual Preparation Time

1 p.m. Individual Preparation Time

1:30 p.m. Campus Tours

4 p.m. Information about Insurance Fringe Benefits, Apr 223

Thursday

8 a.m. Information about the Insurance Fringe Benefits, Forum 309 (Repeat).

9 and 10:30 a.m. Learning Resource Center tours. Meet at circulation desk in library on 2nd floor of Center Building.

1 p.m. Departmental Activities or Individual Preparation Time

3 p.m. Instructional Council, Board Room

TONIGHT, the Oregon Personnel Guidance Association meets at 7:30 in the Eugene Water and Electric Board cafeteria. Morlan Lewis will speak on the "Comprehensive Health Plan." Other business will concern a parent education committee report and a progress report on development of standards for counselor performance and certification. All persons interested in or working with the helping professions are invited to attend OPGA meetings.

LCC WILL HOST the southwest region fall conference of the Oregon Association for Supervision of Curriculum Development. The Sept. 23 program will include LCC Study Skills Center Director Howard Bird, who will speak on "Individualizing Instruction in the Study Skills."

FOR SALE: Maytag washer and dryer, a bargain at \$50. Call Chuck Lamb at Ext. 288 or 345-1738.

WANTED TO RENT: One or two-bedroom house or duplex, unfurnished except for appliances. Needed before Oct. 10. Contact Nancy Paulus, Ext. 351, 352. Will pay \$100-\$115. per month.

PUPILS SEEN AS VICTIMS OF UNTESTED PROGRAMS

A majority of U.S. schools may be using mediocre educational materials simply because no one has bothered to check their effectiveness. Chiefly to blame are school administrators who fail to demand "learner verification," according to P. Kenneth Komoski, president of the Educational Products Information Exchange Institute (EPIE). At a time of national concern over consumer protection, Komoski contends, "the largest single group of unprotected consumers is made up of 50 million school children now required to use thousands of inadequately evaluated educational materials purchased by schools each year." EPIE, a nonprofit "consumers union" for schools located at 386 Park Ave. S, NYC 10016, has taken on some of this evaluation job. Formed in 1967 by the Regents of the State U. of New York, EPIE conducts independent studies of educational materials and equipment and publishes its findings in product reports for which its 3,500 members in schools, colleges and other institutions pay a yearly fee of \$35.

An EPIE analysis of the current 60 "best selling" textbooks has revealed that fewer than 10% had ever been field tested prior to publication. In testimony before the House select subcommittee on education, Komoski noted that an EPIE telephone survey of major educational producers turned up comments such as this from a senior vice president: "We have about 160 salesmen and consultants who report back what they pick up in the field; that's really our field testing." When firms do evaluate materials with students, Komoski pointed out, it is usually done just prior to publication with no chance of using results to revise and improve the product. The amount of field testing done for films used in schools is even less than for textbooks, Komoski asserted. In the area of broadcast video instruction, he said, "we discovered that only three of the 223 materials used in over 85% of broadcast television instruction have been learner tested."

By far the most discouraging area EPIE has investigated is that of programmed instruction, according to Komoski. He said an examination of 633 programmed items now in use in major curriculum areas revealed that research evidence was available for only 7% of these materials, while some "field testing" was claimed for another 8%. Part of the problem, Komoski believes, is the sheer magnitude of educational materials available. There are at present well over 200,000 educational materials being marketed to schools. Komoski argues: "Today's teachers and students do not need an ever-increasing quantity of options. What they need desperately are high quality alternatives to the inadequately developed materials they are now required to use."

But educators are sometimes considered poor judges of the effectiveness of learning materials. Komoski cited a study in which a group of teachers and a principal were asked to review and rate a set of educational materials. The correlation between their judgments and the actual performance of the materials with learners was "strikingly unsuccessful" (-.75). Despite this, he noted, most schoolmen "continue to put their faith solely in examination and review rather than evidence of actual performance when judging educational materials." Improvement comes when developer and user cooperate, he said. An example is the First Year Communications Skills Program developed by the Southwest Regional Laboratory for Educational Research and Development. Designed for use with kindergarten children, the program covers skills such as naming letters of the alphabet and reading simple selections. The program's material was continuously tried out with learners and revised accordingly. The Southwest laboratory admits it wasn't successful at first but after four years of continuous evaluation and revision it has a product that has been verified through use with more than 30,000 children in 12 states.

This kind of trial and error testing is slow, costly and often impossible for small companies, Komoski admits. The only institution that could do adequate testing, some educators believe, is the proposed National Institute of Education. Komoski advises schools to press companies for learner verification and indicate their willingness to serve as sites where producers of educational materials could carry out their studies.

Thursday

Submit items for the Daily to
Kathy Dave, Ext. 340 or second
floor Administration.

September 16, 1971

IN-SERVICE TODAY:

- 8 a.m. Insurance Information (Fringe Benefits) Forum 309 (repeat).
- 9 and 10:30 a.m. Learning Resource Center tours. Meet at the circulation desk in library on 2nd floor of Center Building.
- 1 p.m. Departmental Activities or Individual Preparation Time
- 3 p.m. Instructional Council Meets, Board Room.

FRIDAY

- 9 a.m. Departmental Activities or Individual Preparation Time
- Classified Section Meeting. Speaker is Dr. Ken Hills, Director of Counseling, Apr 223-4.
- 1 p.m. Individual Preparation Time

FOOD SERVICE FACILITIES will close at 1 p.m. tomorrow afternoon to allow the custodial staff to put a sealer on the floors. Service in the Snack Bar will resume Monday, Sept. 18 at 7 a.m. Full Food Service operations will reopen on Oct. 4 with the beginning of classes.

TELEPHONE EXTENSION CHANGES: Math, 386; Art & Applied Design, 306; Purchasing, 304; and Janice Brandstrom, 381.

ABSENTEE BALLOTS FOR THE SEPT. 28 ELECTION are available starting today at the Elections Department at the Court House. Those who will be out of town or otherwise unable to vote on election day are urged to cast ballots ahead of time.

SEVERAL DEPARTMENTS have inquired about the address of Oregon's newest community college Rogue Community College. Here it is: Rogue Community College
3345 Redwood Highway
Grants Pass, OR 97526

WOMEN GOLFERS from the LCC staff are invited to tee off Friday Sept. 17 (tomorrow) at 2:30 p.m. at Green Acres Golf Course, 1375 Irving Road. Cost is \$1.25 for 9 holes.

FIRST ANNUAL Washburn Landscaping Co. College Open Golf Tournament has been set for Friday, Sept. 24, at 1 p.m. at the Emerald Valley Golf Course in Creswell. All LCC staffers are encouraged to attend. Please sign up with Sharon Cuddy, Ext. 277. See tomorrow's Daily for further details.

Washington, D.C. • September 13, 1971

COURT DECISION SETS OFF NATIONAL ATTACK

State after state is being hit by legal action in the aftermath of the California State Supreme Court's landmark decision against local school financing. (See EDUCATION U.S.A., Sept. 6, 1971.) Latest count shows 11 states facing--or about to face--legal suits spurred by the decision. Ruling that reliance on local property taxes for school support discriminates against the poor, the court said equal spending for students is a basic right. Foes of traditional school financing see the decision as a clarion call to action. Threatened with suits are Illinois, Maryland, New York, Colorado, Minnesota and Arizona. Added thrust has been given to suits already filed in Texas, Michigan, Ohio, New Jersey and Wisconsin.

Forces behind the suits include school districts with a low tax base, civil rights leaders, parents who feel overtaxed and even some state officials. The Illinois suit was filed by the mayor of Niles township on behalf of himself (overtaxed) and his daughter (shortchanged educationally). Maryland will be sued by the city of Baltimore, according to Mayor Thomas J. D'Alesandro. New York will be riddled with suits. Among the plaintiffs are the city of Rochester and State Assemblyman Stanley Harwood, chairman of the Assembly's Education Committee. Colorado will face action brought by Durant Davidson, a state legislator. Arizona must prepare to defend a suit filed by John Biggers of the Neighborhood Legal Services in Tucson. At least two suits have been announced against Minnesota and others are in preparation.

Added clout for suits against the states will come from two sources--nationally known legal experts and planning strategists. The Washington, D.C., headquarters of the Lawyers Committee for Civil Rights Under Law is acting as a clearinghouse for all legal action that is following in the wake of the California suit. The committee is scheduling strategy sessions in late September that will draw some 45 parties planning suits. Present to advise them will be prestigious legal and educational experts such as David Kirp of the Harvard Law Center; Frank Michelman, Harvard Law School; John F. Coons, U. of California at Berkeley; Harold Horowitz, U. of California at Los Angeles; and Charles Benson, educational economist.

Effects of the California decision could be so far-reaching as to shatter many established school and social patterns. Already state leaders in California, Maryland and Michigan are edging toward Statewide collection of property taxes, with equal distribution to local districts. Educators are wondering how much local control would be lost by the individual districts when they lose the taxing power. Almost certainly, teachers would find themselves bargaining with the state instead of local districts since the state would control the purse strings. Another question being raised by educators: would the "unequal" argument that struck down local taxing in California apply to disparity among the states, too? If the tax base is greater in New York than in Alabama, will the federal government be forced into the role of property tax collector? Social patterns also could be changed by the ruling. If school spending is equalized, the drawing power of wealthy school areas would diminish. People might redistribute themselves into areas that now have a low tax base. Civil rights groups say the decision may ultimately break the barriers against minority-group housing in the suburbs.

THE LCC OPEN DOOR COMMITTEE has established these sub-committees for the Sept. 28 election. Those willing to serve should contact the chairman of the activity in which they're interested.

<u>Sub-committee</u>	<u>Chairman</u>	<u>Telephone Number</u>
LCC Staff for a Comprehensive Comm. College	Paul Malm/Jim Ellison	Campus: 240,355 Home: 747-7164, 688-8070
LCC Students for a Comprehensive CC	Omar Barbarossa/John Klobas Jack Carter	Campus: 221,240, 346 Home: none, 344-8224, 689-2673
U of O Students for LCC	Iain More	UO Campus: 686-3724 Home: 686-8776, 344-4742
U of O Faculty for a Comprehensive CC	Fred Mohr	UO Campus: 686-3176 Home: 342-1040
North Willamette Element	Rick Hillman/Miles Edwards	342-7343, 344-3442
Maude Kerns Patrons for LCC	Jim Bartel	Art Center: 345-1126 Home: 344-1136
Theater & Symphony Patrons for LCC	Ed Ragozzino/Lee Bishop	Campus: 318 Home: 344-9426, 686-2900
Professional Groups for LCC	Bert Dotson	Campus: 332 Home: 747-2114
Advisory Committees for LCC	Deans Case, LaGrandeur, and Rasmussen	Campus: 329, 321, 326
Minorities and Dis-Advantaged for LCC	Jon West/Earl Barrios	Campus: 214, 227, 333 Home: 344-9162, 686-9282
City/County Workers for LCC	to be determined	
Alumni for LCC	Lyle Swetland	Campus: 335 Home: 345-1276
Clergy for LCC	Bert Dotson/Dick Eymann	Campus: 332, 334 Home: 747-2114, 933-2353
Industry for LCC	Bill Watkins/Dick Earl	Campus: 376, 395 Home: 344-4126, 345-4766
Labor for LCC	Joris Johnson	Campus: 323 Home: 747-5827
Farm Vote for LCC	to be determined	Campus: 333

SUPPORT AND ACTION COMMITTEES for Sept. 28 election.

<u>Committee</u>	<u>Chairman</u>	<u>Telephone Number</u>
Facilities Committee	Bill Cox	Campus: 301 Home: 345-4456
Graphics Media Committee	Don Johnson	Campus: 351 Home: 343-0447
Electronics Media Committee	Mike Hopkinson/ Tom Lichty	Campus: 392, 263 Home: none, 344-4610
Newspaper Media Committee	Joyce Harms	Campus: 392 Home: 344-8305
Campaign Fund Committee	Lyle Swetland	Campus: 335 Home: 345-1276
Telephone Committee	Lucy Schafer	Home: 345-1444
Canvassing Committee	Paul Colvin	Campus: 391 Home: 686-1553
Reception Committee	Bert Dotson	Campus: 332 Home: 747-2114
Transportation Committee	Tom Purvis	Campus: 333, 391
Delivery & Courier Service	Tom Purvis	Campus: 333, 391
Election Coordinating Committee	Marston Morgan	Campus: 333 Home: 942-8726

STAFF MEMBERS are reminded that contributions for campaign funds may be made through the Open Door Committee, in care of Development Office.

FOR SALE: German Shepherd puppies, show quality. Call 689-2265 or 688-4923

FOR SALE: Wood-heating stove for sale. \$35 or trade for ? Call 935-3643 after 5 p.m. or contact Carol Beckley, Administration Building.

Submit items for the Daily
to Erika Orchard, Ext. 224
or First floor Administration.

Friday

September 17, 1971

STAFF IN-SERVICE continues:

TODAY

9 a.m. Departmental Activities or Individual Preparation Time

9 a.m. Classified Section meeting. Discussion led by Dr. Ken Hills,
Director of Counseling.

1 p.m. Individual Preparation Time

MONDAY

9 a.m. Panel Discussion "Money Affairs & LCC". Panel members- Bill Watkins,
Dr. Case, Mr. Kreitz and Dick Eymann. All staff are invited.

1 p.m. Departmental Meetings and Activities or Individual Preparation Time.

STAFF ASSOCIATION DUES are now being accepted for the 1971-72 year. Dues are payable by means of payroll deduction from now until Oct. 11, and cash or checks will be accepted any time during the year. The dues, figured for the first time on a percentage of earnings basis, are as follows: Earnings of less than \$3,000, \$3.00; 3,000 to 5,999, \$4.00; 6,000 to 8,999, \$6.00; 9,000 to 11,999, \$8.00; 12,000 to 14,999, \$10 and more than 15,000, \$12.00.

Dues are payable to the following representatives of the Association:

Administrative section- Betty Kepner or Lyle Swetland; Faculty section- Bob Boettcher, Science prof, Jim Evans, Business prof, or Paul Patrick, Mechanics prof; Classified section- Pat Tiller, Registrar's secretary, Judy Piercy, scheduling clerk, or Evelyn Tennis, Dean Rasmussen's secretary.

1971-72 STAFF DIRECTORIES will be available upon request beginning Monday, Sept. 20. Each department secretary should place one order for her department to Kathy Dave, Ext. 340. Please make sure that all staff in the department want a directory before requesting one for each staff member.

TELEPHONE EXTENSION changes and additions: Diesel Mechanics, 361 and 265; Aviation Maintenance Technician, 371; Auto Body, 374; Agricultural & Industrial Equipment Repair, 246.

ATTENTION LCC GOLFERS! The first annual Washburn Landscaping Co. College Open Golf Tournament is scheduled for next Friday, Sept 24 at Emerald Valley Golf Course in Creswell. This year there will be trophies, golf clubs and balls awarded to winners, compliments of Washburn's Landscaping. All LCC staffers are encouraged to sign up by calling Sharon Cuddy at Ext. 277. Be ready to tee off at 1 p.m. Cost: green fees.

LCC WOMEN will meet this afternoon at Green Acres Golf Course, 1375 Irving Road. Cost is \$1.25 for 9 holes. Meet at the club house at 2:30 p.m.

THE MANIPULATIVE portion of the State Electrical Apprenticeship Contest will be held tomorrow in the Apprenticeship Building on campus. The top ten graduates from 4-year apprenticeship programs will compete for skills recognition and trophies. Joint sponsors are the National Electrical Contractors Association and the International Brotherhood of Electrical Workers.

A SCHEDULE OF ACTIVITIES IN SUPPORT OF THE SEPTEMBER 28 BUDGET ELECTION has been established by the LCC Open Door Committee. It is printed below:

Saturday, Sept. 18 - Handout Booth at Saturday Market

Monday, Sept. 20 - LCC new student registration--handouts and recruitments

Tuesday, Sept. 21 - Opening of LCC Information Center, 878 Willamette St.
Press Conference at the Information Center at 9:30 a.m.
General meeting of all committees, Information Center at 9:30 a.m.

Wednesday, Sept. 22 - 8 a.m. to 8 p.m. Information Center open

Thursday, Sept. 23 - 8 a.m. to 8 p.m. Information Center open
U of O Registration handouts
Rally to begin neighborhood canvass, at the Information Center, 5:30 p.m.

Friday, Sept. 24 - 8 a.m. to 8 p.m. Information Center open
U of O Street Fair--handouts, Music and Theatre for LCC
Neighborhood Canvass

Saturday, Sept. 25 - 8 a.m. to 8 p.m. Information Center open
Saturday Market
U of O Street Fair
Neighborhood Canvass

Sunday, Sept. 26 - Reception and Open House at LCC. Tours for the public, 2 p.m.

Monday, Sept. 27 - 8 a.m. to 8 p.m. Information Center open
Neighborhood Canvass
Telephone Canvass

Tuesday, Sept. 28 - ELECTION DAY - telephone and neighborhood canvasses

MONEY, MONEY, MONEY! That's the problem right now for both LCC and the LCC Open Door Committee. "Passing the hat" among staff resulted in about \$350 to help publicize the Sept. 28 election. Further contributions are welcome and needed (and tax deductible. Checks should be made payable to the LCC Open Door Committee, and may be given to Lyle Swetland, Development director, Marston Morgan, Research and Planning director or Jim Ellison, Staff Association president.

PEOPLE, PEOPLE, PEOPLE! Any staff member who knows of any current or former students you think would be interested in participating in the rally Thursday, Sept. 23, please give their names and if possible, phone numbers to Jack Carter, dean of students. The rally will start around 5:30 p.m. and all participants are asked to meet at the Information Center, 878 Willamette St.

Submit items for the Daily to
Erika Orchard, Editor, Ext. 224
or first floor Administration.

Monday

September 20, 1971

SECOND WEEK of In-Service begins this morning with a panel discussion on "Money Affairs & LCC". Panelists are: Bill Watkins, business manager, Dr. Case, dean of Instruction, Jack Kreitz, business department chairman, and Dick Eymann, funding specialist. All staff are invited to attend. Starts at 9 a.m. in Forum 301-2.

1 p.m. Departmental Meetings and Activities or Individual Preparation Time

Tuesday

9 a.m. Departmental Activities or Individual Preparation Time

1 p.m. Individual Preparation Time

3 p.m. College Cabinet meets, Board Room

11 a.m. Tunnel Tours- Tours of the tunnel system which connects all of the buildings on campus underground will start at 11 and last about 30 minutes. There are two tours to choose from: one will require that you negotiate two vertical ladders, the other is an easy walking tour. If you're interested call Gina Ing at Ext. 332.

ALL executive secretaries and chairmen for all Advisory Committees will be attending a meeting tomorrow night at 7:30 in the Board room to discuss next Tuesday's (Sept. 28) budget election and the effect on LCC.

"QUICKIES" available in LRC Building. Quick "tailor-made" tours of the Learning Resource facilities are available today and Wednesday for all staff. Tours will be arranged to take only as much time as staff members have to spare. Individuals or small groups can be accommodated at their convenience. Call Del Matheson, librarian at Ext. 211.

STAFF MEMBERS and students willing and eager to help with the election should contact the chairman of the sub-committee of their choice today. Committees are reminded that any materials disseminated must first be checked by Larry Romine, Information & Publications director and Dick Eymann, funding specialist, for necessary disclaimers.

WE'VE been so busy with election reports and registration figures that the Daily has been slipping up on the birthdays and anniversaries. It's a little late but Happy Birthday Ada Zinser, bookstore manager and Happy Anniversary Mary Gay, warehouse clerk.

REGISTRATION FOR NEW STUDENTS BEGAN THIS MORNING AT 8 a.m. IN THE GYM.

KNOW YOUR polling place for next week's budget election? Here they are, why not take a few friends to the polls with you.

PRECINCT	POLLING PLACE		
Those portions of School Districts 42J-Harrisburg 46, Harris, and 63J-Wyatt in Linn, Benton and Lane Counties in the LCC District.	Harrisburg High School	Santa Clara No. 3	Spring Creek School, 560 Irvington Drive
Those portions of Monroe Elementary School School District 25J Monroe in Lane, Linn, and Benton Counties in the LCC District.	Monroe Elementary School	Santa Clara No. 6	Silver Lea School, 250 Silver Lane
Alvadore	Danebo School, 1265 Candlelight Dr.	Santa Clara No. 7	Silver Lea School, 250 Silver Lane
Armitage No. 3	Yolanda School, 2350 Yolanda St.	Santa Clara No. 8	Santa Clara Fire Station, 2600 River Road
Armitage No. 6	Yolanda School, 2350 Yolanda St.	Santa Clara No. 9	Spring Creek School, 560 Irvington Drive
Bailey	Danebo School, 1265 Candlelight Dr.	Santa Clara No. 10	Santa Clara Fire Station, 2600 River Road
Blackby	Triangle Lake Elementary School	Santa Clara No. 12	Spring Creek School, 560 Irvington Drive
Blanton	Edgewood Elementary School, 577 E. 46th Ave.	Silk Creek	American Legion Hall, 832 W. Main St., Cottage Grove
Blue River	School District Administration Building, Finn Rock	Swisshome	Evangelical Church of North America, Swisshome
Coburg	Coburg Fire Station, Coburg	Thurston	Thurston High School, 333 N. 58th St.
College Crest	Crest Drive School, 1155 Crest Drive	Veneta City	Veneta City Hall, Veneta
Cottage Grove No. 1	Masonic Temple, 820 W. Main St.	Walterville	Millican Community Hall, Walterville
Cottage Grove No. 2	Masonic Temple, 820 W. Main St.	Walton	Noti Elementary School, Noti
Cottage Grove No. 3	Masonic Temple, 820 W. Main St.	Westfir	Oakridge Elementary School, 1st & Willow, Oakridge
Cottage Grove No. 4	Masonic Temple, 820 W. Main St.	Wilkins	Coburg Fire Station, Coburg
Cottage Grove No. 5	Masonic Temple, 820 W. Main St.	Willagillespie	Sheldon Meadows Community Center, 2445 Willakenzie Rd.
Creswell	Creslane Elementary School, 996 W. "A" St.	Willakenzie No. 2	Guy Lee School, 4300 Harlow Rd.
Creswell City	Creslane Elementary School, 996 W. "A" St.	Willakenzie No. 4	Sheldon Meadows Community Center, 2445 Willakenzie Rd.
Crow	Veneta City Hall, Veneta	Eugene No. 103	Roosevelt Jr. High School, 680 E. 24th Ave.
Culp Creek	Culp Creek School, Culp Creek	Eugene No. 105	Fire Station, 50 E. 33rd Ave.
Danebo	Danebo School, 1265 Candlelight Dr.	Eugene No. 107	Ellis Parker School, 3875 Kincaid St.
Douglas Gardens	Mount Vernon School, 725 S. 42nd St.	Eugene No. 109	Ellis Parker School, 3875 Kincaid St.
Elmira	Veneta City Hall, Veneta	Eugene No. 117	Spencer Butte Jr. High School, 500 E. 43rd Ave.
Fall Creek	Lowell High School, Lowell	Eugene No. 121	Ellis Parker School, 3875 Kincaid St.
Fern Ridge	Veneta City Hall, Veneta	Eugene No. 201	Celeste Campbell Community Center, 155 High St.
Florence	Florence City Hall, Florence	Eugene No. 205	South Eugene High School, 400 E. 19th Ave.
Garden Way	Centennial School, 1415 Aspen Way	Eugene No. 209	South Eugene High School, 400 E. 19th Ave.
Glenada	Florence City Hall, Florence	Eugene No. 219	Condon School, 1787 Agate St.
Glenwood	James Center, 4140 E. 19th Ave.	Eugene No. 221	Condon School, 1787 Agate St.
Goshen	Pleasant Hill Elementary School Gym, Pleasant Hill	Eugene No. 227	Roosevelt Jr. High School, 680 E. 24th Ave.
Grovedale	Guy Lee School, 4300 Harlow Rd.	Eugene No. 233	Edison School, 1328 E. 22nd Ave.
Harbor	James Center, 4140 E. 19th Ave.	Eugene No. 239	Edison School, 1328 E. 22nd Ave.
Heceta	Florence City Hall, Florence	Eugene No. 245	Edison School, 1328 E. 22nd Ave.
Central Irving	Irving Fire Station, Prairie Road, Irving	Eugene No. 301	Willakenzie Fire Station, 780 Coburg Rd.
East Irving	Irving Fire Station, Prairie Road, Irving	Eugene No. 305	Willakenzie Fire Station, 780 Coburg Rd.
Jasper	Mt. Vernon Elementary School, 725 S. 42nd St.	Eugene No. 313	Willakenzie Fire Station, 780 Coburg Rd.
Junction City No. 1	Junction City, City Hall, 680 Greenwood St.	Eugene No. 315	Meadowlark School, 1500 Queens Way
Junction City No. 2	Junction City, City Hall, 680 Greenwood St.	Eugene No. 319	Meadowlark School, 1500 Queens Way
Lancaster	Lutheran Church Parish Hall, 926 W. 6th St., Junction City	Eugene No. 401	Washington Street Recreation Center, 2017 Washington St.
Latham	American Legion Hall, 832 W. Main St., Cottage Grove	Eugene No. 405	Washington Street Recreation Center, 2017 Washington St.
Leaburg	Leaburg-McKenzie Community Center, Leaburg	Eugene No. 407	Ida Patterson School, 1510 Taylor St.
London	American Legion Hall, 832 W. Main St., Cottage Grove	Eugene No. 411	Ida Patterson School, 1510 Taylor St.
Lorane	American Legion Hall, 832 W. Main St., Cottage Grove	Eugene No. 413	Westmoreland School, 2285 W. 18th Ave.
Lost Valley	Lowell High School, Lowell	Eugene No. 419	Crest Drive School, 1155 Crest Drive
Lowell	Lowell High School, Lowell	Eugene No. 421	Frances Willard School, 2855 Lincoln St.
Mapleton	Mapleton Lions Club	Eugene No. 425	Frances Willard School, 2855 Lincoln St.
Marcola	Marcola School	Eugene No. 427	Frances Willard School, 2855 Lincoln St.
Mercer	Florence City Hall, Florence	Eugene No. 433	Fire Station, 50 E. 33rd Ave.
Mosby	American Legion Hall, 832 W. Main St., Cottage Grove	Eugene No. 501	Fire Station, 1085 W. 1st Ave.
Norkenzie	Sheldon Meadows Community Center, 2445 Willakenzie Rd.	Eugene No. 513	Fire Station, 900 McKinley St.
Noti	Noti Elementary School, Noti	Eugene No. 521	Lincoln Elementary School, 650 W. 12th Ave.
Oakridge No. 1	Oakridge Elementary School, 1st & Willow, Oakridge	Eugene No. 527	Lincoln Elementary School, 650 W. 12th Ave.
Oakridge No. 2	Oakridge Elementary School, 1st & Willow, Oakridge	Eugene No. 531	Lincoln Elementary School, 650 W. 12th Ave.
Pleasant Hill	Pleasant Hill Elementary School, Pleasant Hill	Eugene No. 535	Washington Street Recreation Center, 2017 Washington St.
East Prairie	Junction City, City Hall, 680 Greenwood St.	Eugene No. 541	Ida Patterson School, 1510 Taylor St.
West Prairie	Lutheran Church Parish Hall, 926 W. 6th St., Junction City	Eugene No. 551	Westmoreland School, 2285 W. 18th Ave.
Richardson	Lutheran Church Parish Hall, 926 W. 6th St., Junction City	Eugene No. 601	Fire Station, 900 McKinley St.
River Road No. 1	River Road School, 120 W. Hilliard Lane	Eugene No. 607	Fire Station, 500 Bernsten Road
River Road No. 3	River Road School, 120 W. Hilliard Lane	Eugene No. 615	Fire Station, 500 Bernsten Road
River Road No. 6	Howard School, 700 Howard Ave.	Eugene No. 617	Malabon School, 1380 Taney St.
River Road No. 8	Howard School, 700 Howard Ave.	Eugene No. 621	Malabon School, 1380 Taney St.
Saginaw	Creslane Elementary School, 996 W. "A" St., Creswell	Springfield No. 1	Mill St. School Administration Bldg., 525 Mill St., Springfield
Salmon Creek	Oakridge Elementary School, 1st & Willow, Oakridge	Springfield No. 2	Mill St. School Administration Bldg., 525 Mill St., Springfield
Santa Clara No. 2	Santa Clara Fire Station, 2600 River Road	Springfield No. 3	Mill St. School Administration Bldg., 525 Mill St., Springfield
		Springfield No. 4	Springfield Library Annex, 320 N. "A" St., Springfield
		Springfield No. 5	Springfield Library Annex, 320 N. "A" St., Springfield
		Springfield No. 6	Springfield Jr. High School, 1084 "G" St., Springfield
		Springfield No. 7	Springfield Jr. High School, 1084 "G" St., Springfield
		Springfield No. 8	Maple Elementary School, 21st & "J" St., Springfield
		Springfield No. 9	Maple Elementary School, 21st & "J" St., Springfield
		Springfield No. 10	Eastern Lane Fire Patrol Station, 3150 Main St., Springfield
		Springfield No. 11	Eastern Lane Fire Patrol Station, 3150 Main St., Springfield
		Springfield No. 12	Eastern Lane Fire Patrol Station, 3150 Main St., Springfield
		Springfield No. 13	Fire Station No. 2, 48th & Main St., Springfield
		Springfield No. 14	Fire Station No. 2, 48th & Main St., Springfield

September 20, 1971

WHAT ARE THE FACTS

ABOUT LCC'S BUDGET ELECTION?

1. Scheduled for TUESDAY, SEPTEMBER 28 at COUNTY polling places. (If you're not sure where you vote, call the LCC INFORMATION CENTER, 343-5216, or Lane Community College, 747-4501, ext. 332.

2. A YES vote September 28 will NOT increase taxes.

The LCC tax rate will remain at \$1.52 per \$1,000 assessed value--the same as last year. Property taxes will not increase unless the property has been re-appraised.

3. A NO vote September 28 will result in SEVERE RESTRICTIONS ON EDUCATION at LCC.

- * LCC's budget request to the voters has already been reduced from the original \$1.25 million to \$499,079.

Even though the present budget is based on the same tax rate as last year, it will not go as far because of the increased cost for the same services.

This reduction in the budget ALREADY means:

- a. fewer classes can be offered
- b. approximately 2,000 people who wanted to attend LCC this year can't be admitted
- c. larger classes than are desirable for the best education
- d. reduction in the number of staff members
- e. cuts in some programs

- * IF THE SEPTEMBER 28 BUDGET IS DEFEATED, IT MEANS:

- a. about 2,000 MORE people would have to be turned away. Most of these have no access to higher education except LCC
- b. LCC's VOCATIONAL PROGRAMS would be hardest hit, because they are the most expensive

4. WOULD FURTHER LIMITS ON ENROLLMENT HELP?

Limiting enrollment further is not the solution for LCC's financial problems.

Only about 25% of the total LCC budget comes from local property taxes. 75% is from other sources such as state and federal funds and tuition.

LCC receives about \$840 for each full-time equivalent student from state money and tuition. The fewer students we have, the more money we lose from sources other than property taxes.

5. WOULD ELIMINATING LOWER DIVISION CLASSES HELP?

Eliminating lower division classes (sometimes called "college transfer" classes) would not help LCC's financial situation.

In fact, eliminating lower division classes would greatly INCREASE financial difficulties.

Lower division classes cannot realistically be eliminated because many of them are INTEGRAL PARTS OF VOCATIONAL-TECHNICAL PROGRAMS.

Science classes, for example, are technically "lower division," but are required for students in LCC's para-medical programs. Math classes are "lower division," but are essential to students in industrial technology.

Not only are many lower division classes essential to vocational-technical programs, they also help SUPPORT VOCATIONAL PROGRAMS FINANCIALLY.

Typical lower division classes cost less to operate than the \$840 received in state funds and tuition per full-time equivalent student.

Typical vocational-technical classes cost more than \$840.

THUS, LOWER DIVISION CLASSES ARE HELPING LOCAL TAXPAYERS SUPPORT LCC'S VOCATIONAL PROGRAMS. Eliminating them would mean more funds for vocational programs would have to come from the local taxpayer.

6. WHERE CAN YOU GET INFORMATION ABOUT LCC AND THE BUDGET?

The LCC Open Door Committee (a group of volunteers) has opened an LCC INFORMATION CENTER at 878 Willamette Street in Eugene (formerly Heath's Wonder Fabrics).

The Center is open from 10:00 a.m. to 10:00 p.m. through September 28.

Stop by, or call 343-5216.

Submit items for the Daily to
Erika Orchard, Ext. 224, or
first floor, Administration.

Tuesday

September 21, 1971

TODAY'S EVENTS

REGISTRATION CONTINUES by priority number for new students

No.'s 1,001 - 1,500 8 a.m. - 12 noon
1,501 - 2,000 1:30 - 5:30 p.m.

- 9 a.m. IN-SERVICE: Departmental activities or individual preparation time
- 9:30 a.m. LCC INFORMATION CENTER OPENS. Press conference with Dr. Schafer,
878 Willamette St. (formerly Heath's Wonder Fabrics)
- 11 a.m. TUNNEL TOURS - a 30 min. hike through the underground system
connecting all campus buildings. MEET in Center Bldg. lobby.
- 1:30 p.m. IN-SERVICE: Seminar on individualized instruction
LCC staff members will share their ideas and experiences
with "package learning" and other individualized learning approaches.
- 3 p.m. COLLEGE CABINET MEETING, Board room
Agenda items: * review of budget preparation
* election activities progress report
* staff attitude survey
* upcoming Board meetings
* in-service and delay in college opening
- 3:30 p.m. DR. KEN HILLS will repeat his address to the classified staff
on "Communication." All who were unable to attend earlier
are encouraged to hear Dr. Hills today. PLACE: staff lounge,
second floor, Center.

WEDNESDAY

- 8 a.m. Social security benefits explained by Stewart Curry of Social Security
Administration. FORUM 311
- 11 a.m. FACULTY SECTION MEETS Forum 309
Ted Romoser will report on progress of the Faculty Evaluation Committee.
- 1 p.m. REPEAT of morning social security information session For. 311.



INFORMATION CENTER OPENS: A weekend painting party transformed
the former Heath's Wonder Fabrics store into a sunshine yellow
LCC Information Center at 878 Willamette on the downtown mall.

The Open Door Committee will officially begin operation of
the election information center this morning with a 9:30a.m. press
conference. Dr. Schafer and other college officials will be on
hand to discuss the budget and answer questions from the press.

continued

INFORMATION CENTER, cont.

During the next week, the Center will be open from 10 a.m.-10 p.m. daily. It will be staffed by volunteers ready to answer citizens' questions about the Sept. 28 election and the college. Questions may also be called in. The Information Center's telephone number is 343-5216.

THANKS FOR THE "INTERIOR DECORATING" at the Information Center go to the Sunday painting crew: Joyce Harms, Jim Ellison, Betty Ekstrom, Mark Parrish, Eric Torkelson, Steve Turner, Maryann Miller, and the Snows (Jim, Barbara, and their daughters).

THE ATTRACTIVE WINDOW DISPLAY is the work of DAVE SHERMAN, performing arts prof.

COMING UP THIS WEEK:

* THURSDAY Student Rally at LCC Information Center. 12:30 p.m. (note time change). Rally will be followed by neighborhood canvassing.

* FRIDAY All-Campus Breakfast - 7:30-9 a.m. Restaurant area
Students, staff, Board members, friends of LCC invited
*Cost: \$1.25
Menu: Choice of ham or bacon
eggs
hashed brown potatoes
hot biscuits, fruit preserves
coffee or tea

* Low on funds? grab a doughnut and coffee at the snack bar and join the others at the breakfast.

* SATURDAY Bake Sale - Oakway Mall - 9:30 a.m. until goodies run out
Sponsored by the Open Door Committee, JOLENE BOWERS, Special Training Programs secretary, chairman.
Proceeds will be used to defray costs of election week activities by Open Door Committee.



COOKIES, CAKE, FUDGE, BREADS----whatever your baking specialty is--WE NEED IT, Jolene says. Bring your baked goods to the Special Training Programs Dept. Friday or to the Oakway Mall Saturday. OR--JORIS JOHNSON, adult ed. coordinator, has volunteered to be the pick-up and delivery man.
(One staff member has already promised 5 lbs. of fudge)

WORKERS NEEDED, TOO. Call Jolene at 348.

Wednesday

DROP BY the LCC Information Center anytime between 10-10 (through Sept.28).

The volunteer staff needs your support.

September 22, 1971

TODAY'S EVENTS

REGISTRATION CONTINUES - gymnasium

10 a.m. CURRICULUM COMMITTEE MEETS Board Room

11 a.m. FACULTY SECTION MEETS Forum 309
Ted Romoser, language arts prof, will report on Faculty Evaluation Committee

1 p.m. SOCIAL SECURITY benefits explained. REPEAT of morning session. Forum 311

7:30 p.m. SPECIAL BOARD MEETING Board Room

The Board is expected to name a replacement for former Board member Dean Webb and to consider delaying plans for the proposed auditorium-music building, pending further review and a public hearing.

The field of eight candidates for appointment to Webb's unexpired term was narrowed to two candidates on Sept. 8. An informal secret ballot resulted in a deadlock, with the votes split 3-3 for Ken Kesey of Pleasant Hill and Stephen Reid of Fall Creek. The Board will meet privately before the public session tonight and attempt to resolve the deadlock.



THE RESPONSE to the call for volunteers to help publicize the Sept. 28 election has been overwhelming--several hundred students, staff, and friends of the college are working throughout the community on various campaign activities.

BUT -- financial support is still needed by the Open Door Committee. Several mailings are being held up for lack of postage money.

YOUR CONTRIBUTION WILL BE PUT TO GOOD USE. Send donations to Lyle Swetland, Marston Morgan, or Jim Ellison. Checks should be made payable to LCC Open Door Committee.

MORE THAN 200 LCC students have signed up to participate in Thursday's 12:30 p.m. election rally at the LCC Information Center, 878 Willamette. The rally will kick off three days of neighborhood canvassing during which students will distribute election information and encourage citizens to call the information center if they have questions about LCC or the election.

CARS AND DRIVERS are needed for the Open Door Committee's transportation pool. If you would be willing to drive citizens to the campus Sunday, Sept. 26, during the open house (2-5p.m.) or to the polls on election day, Tuesday, contact Tom Purvis, Ext. 333. Gas expenses will be reimbursed.

Voc-ed courses cost more, says Lane college leader

By LLOYD PASEMAN
Of the Register-Guard

Turning Lane Community College into a school offering only technical-vocational courses would cost more — not less — local property tax dollars, LCC President Eldon Schafer said Tuesday.

Schafer, speaking at the opening of an "LCC Information Center" in downtown Eugene, said "some taxpayer-voters mistakenly believe it would save tax dollars if LCC would replace the comprehensive community college concept with complete concentration on vocational-technical skills."

Actually, he said, the reverse is true.
"If we offered only a selected

liberal arts curriculum," Schafer said, "the college could conceivably exist without any local tax support."

"In contrast," he said, "concentration on vocational-technical programs, to the exclusion of the liberal arts disciplines, would involve additional expense to local taxpayers which might really shock the cost-conscious citizen."

Schafer said vocational-technical classes cost more than liberal arts classes because they require smaller class size and involve higher costs in "facilities, equipment and instruction."

The LCC president said he was addressing his remarks to a "vocal minority of our citizens (who) would like to reject

the basic premise which differentiates a community college from a vocational school" — that being the inclusion of a two-year liberal arts program for those students who want it.

The new information center, at 878 Willamette St., is being financed by a group of citizens calling themselves the "LCC Open Door Committee." Volunteers — including LCC faculty, staff and students — are helping man the center operation.

The center will operate from 10 a.m. to 10 p.m. daily through Sept. 28, the date of a fourth election on a 1971-72 property tax levy to support LCC's operating budget.

The college is asking for \$499,079 outside its \$1.69-million operating tax base. Officials es-

timate that the college's overall tax rate would stay at its 1970-71 level of \$1.52 per \$1,000 of true cash value.

Persons with questions about the college or about next Tuesday's tax levy election are invited to stop by or telephone the center at 343-5216.

Schafer said he is concerned that another tax levy election defeat for LCC this year will force the college to "limit growth in the classes which tap the till most deeply."

He noted that the college has thus far this fall maintained a "balance" in its fall term registration, with about half the students enrolling in vocational courses and half in liberal arts courses.

"It is imperative," said Schafer, "that our citizens understand there is no economy in eliminating liberal arts programs; and that LCC is firmly committed to expanding and improving its technical-vocational programs to the very outer limits of the tax funds made available to us by the voters."

In a preliminary announcement Tuesday, Schafer said he will recommend to the LCC Board at a special meeting Wednesday night that it invite the board of the Lane County Auditorium Assn. to "participate in a joint review" of auditorium facilities being planned by both agencies.

He said he will recommend further planning on the proposed LCC facility be delayed pending public "re-examination of any possibility of merger or multiple use of these proposed public facilities."

In elaborating on his comments Tuesday on the comparatively higher cost of vocational training, Schafer said the college — through a recently developed "program cost accounting" procedure — has calculated that, on the average, an LCC "occupational" course costs \$260 more per student than a liberal arts course.

To illustrate, he said the college's social science department program costs \$794 per full-time student while the LCC parodontal (dental assistant, hygienists, etc.) operation costs \$1,862 per student.

Schafer said the college receives about \$840 per full-time student annually in state tax support and tuition. "It becomes obvious that any class which operates for less than \$840 is, in effect, helping carry the financial burden of classes which cost more than \$840 to operate," he said.

"Thus," he said, "the (liberal arts programs) are helping local taxpayers support the vocational programs at Lane Community College."

Eugene Register Guard
Sept. 21, 1971

"A COMPREHENSIVE COMMUNITY COLLEGE like LCC trains BOTH hands and minds-- not human machines to be junked when a new technological idea comes along."
--Dr. Schafer

Thursday

September 23, 1971

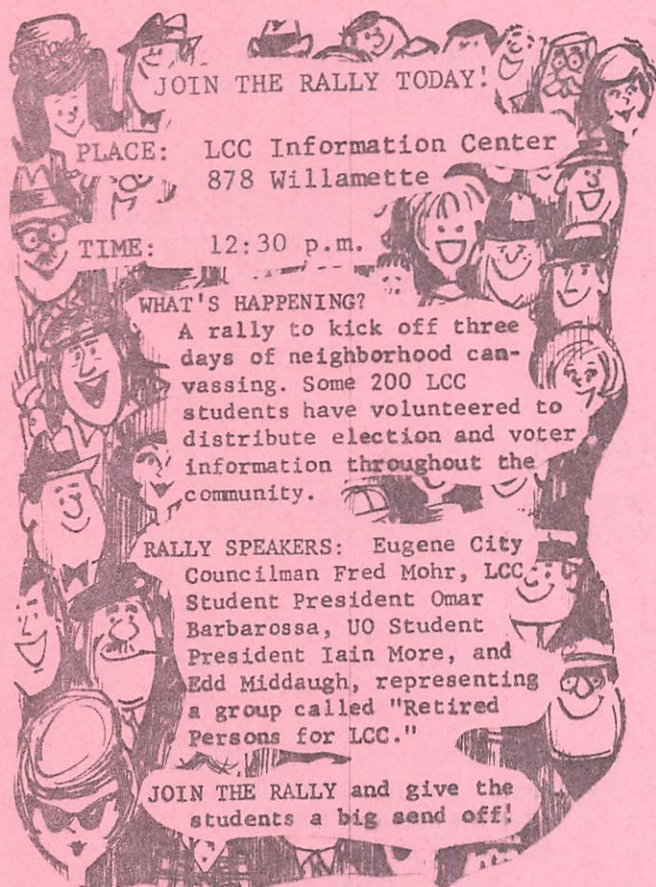

TODAY'S EVENTS

- 10 a.m. Public Employees Retirement System benefits explained Forum 301
- 10 a.m. ADMINISTRATIVE SECTION MEETS-Board Rm.
- 12:30p.m. ELECTION RALLY - LCC Information Center
- 1:30p.m. INSTRUCTIONAL COUNCIL meets - Board Rm.
- 4 p.m. Fall Conference of Oregon Association for Supervision of Curriculum Development. Staff invited. Theme: "Focus on the Individual"

FRIDAY

- 7:30-9 a.m. ALL-CAMPUS BREAKFAST - cafeteria hearty meal for \$1.25. Coffee and doughnuts on sale, too.
- 1 p.m. FIRST ANNUAL WASHBURN LANDSCAPING CO. College Open Golf Tournament-Emerald Valley Course, Creswell. All staffers - that includes the ladies, too - invited. Sign up by calling Ext. 277.

REGISTRATION HOURS TODAY have been extended to 8:30 p.m. to accommodate working students. The registration period for new and returning students has been extended through Thursday of next week to allow students unable to get classes they desired to consult a counselor and select alternates to fill their schedules.

a note from Maryann Miller,
Information Center coordinator...

STAFF MEMBERS--you're invited to visit the Center this weekend, especially Saturday. Meet the people as they inquire about LCC. An hour at the Info. Center gives a notion of what some people REALLY think about LCC.

SUNDAY OPEN HOUSE PLANNED: Area residents will have an opportunity to get a student's view of the LCC campus Sunday by attending an afternoon Open House and reception set for 2-5 p.m.

Each department has been asked to have representatives on hand to show visitors their facilities and to answer questions about the programs offered. ALL STAFF AND STUDENTS are encouraged to come out and help host the visitors.

Throughout the afternoon, musical entertainment will be featured on the terrace and refreshments served in the cafeteria.

THE OPEN DOOR COMMITTEE will be providing transportation to the Open House from the LCC Information Center each half-hour between 2-5 p.m.

OPEN DOOR COMMITTEE NEEDS:

**** MONEY - help defray election activity costs. Send donations to Lyle Swetland.

**** DRIVERS - to provide transportation to the Open House, Sunday, 2-5 p.m. and on election day, Tuesday. Gas expenses will be reimbursed. Call Tom Purvis, Ext. 333.

**** BAKED GOODS - For Saturday's Bake Sale at Oakway Mall. Bring baked goods to sale at 9:30 a.m. Saturday or to Jolene Bowers, Special Training Programs Dept. Tomorrow. You may also arrange to have your donation picked up Saturday morning by calling Jolene, Ext. 348.

REID NAMED TO VACANT BOARD SEAT

Stephen L. Reid, a Fall Creek rancher and logger, was selected last night to fill the Zone 4 Board position vacated by the resignation of Dr. Dean Webb of Cottage Grove.

Reid, 43, will serve by appointment until June 30, 1972, when Dr. Webb's term expires. He will then have to seek election to a four-year term to retain the seat.

The new Board member has served on a number of education committees in the Lowell school district and has expressed an active interest in the vocational as well as the academic development of the community college program. Reid is the father of two college students--Jan, 17, an LCC freshman, and Patti, 19, a junior at the University of Oregon. Two other Reid children, Steve, 16, and Danny, 15, attend Lowell High School.

However, the size of the Reid family has rarely been as small as six in recent years since Reid and his wife Natalie have been foster parents to over 25 children, mostly teenagers.

A graduate of Elmira High School, Reid attended Southern Oregon College before joining the U.S. Air Force in 1951. He operates a cattle ranch on Winberry Creek and is a partner in the S & J Logging Co. Formerly, Reid was employed as a heavy equipment operator with the International Paper Co.

The LCC Board considered eight candidates for the Zone 4 position representing the Cottage Grove, Creswell, Lowell, Pleasant Hill, and Oakridge school districts.

PLANS FOR MUSIC-AUDITORIUM FACILITY HALTED

During last night's special Board meeting, the shortest in many months (25 min.), the Board delayed further action on the proposed music-auditorium facility and scheduled an Oct. 27 meeting with the Lane County Auditorium Association. Representatives from LCC and the LCAA will discuss the possibility of duplication of facilities planned by both bodies and their common goals.

THE OREGON ASSOCIATION OF NURSES has endorsed the LCC Budget.

Friday

Submit items for the Daily to
Erika Orchard, Ext. 224 or
first floor, Administration.

September 24, 1971

A BUSY WEEKEND IS AHEAD FOR OPEN DOOR COMMITTEE VOLUNTEERS. If you haven't been involved in the activities yet, HERE'S YOUR CHANCE:

TODAY'S EVENTS

- ** LCC INFORMATION CENTER - open 10 a.m. - 10 p.m. 878 Willamette
Drop by and talk to local residents inquiring about LCC and the election
- ** STUDENT NEIGHBORHOOD CANVASS continues

SATURDAY

- ** OPEN DOOR COMMITTEE BAKE SALE - 9:30 a.m. Oakway Mall
Proceeds used to defray election costs. SALE SPECIALS: homemade bread-hot from the oven, rye bread, Swedish pastries.
WHY NOT DO YOUR WEEKEND DESSERT SHOPPING AT THE SALE!
- ** LCC INFORMATION CENTER - open 10 a.m. - 10 p.m.
Why not plan to volunteer an hour or more of your time to help man the center
- ** ELECTION INFORMATION BOOTH at Saturday Market
- ** STUDENT NEIGHBORHOOD CANVASS continues

SUNDAY

- ** LCC INFORMATION CENTER - open 10 a.m. - 10 p.m.
- ** ALL-CAMPUS OPEN HOUSE - 2 p.m. - 5 p.m.
Plan to be on hand to host the visitors

OPEN DOOR COMMITTEE NEEDS:

- ** BAKED GOODS for Saturday's sale. Bring to Oakway Mall at 9:30 a.m. or call Jolene Bowers, Ext. 348, to arrange for someone to pick up your donation.
- ** DRIVERS to provide transportation to the campus Saturday and election day. Gas expenses reimbursed.
Drivers needed: 2-5 p.m. Sunday
8 a.m.-7:30 p.m. Tuesday
Call Tom Purvis, Ext. 333.
- ** MONEY! That's the problem for both LCC and the Open Door Committee. Hundreds of posters, fact sheets, and other campaign materials are being distributed by volunteers. THESE MATERIALS MUST BE PAID FOR BY OPEN DOOR CONTRIBUTIONS.
About \$500 has been collected. Further donations are needed (and are tax deductible). Send to Lyle Swetland, development office.

OPEN HOUSE

SUNDAY- 2-5 p.m.

A chance to get a student's view of the LCC campus will be offered area residents during Sunday's Open House from 2-5 p.m.

We hope all staff members and students will plan to be on hand to show visitors through the facilities and answer questions about LCC training programs.

Throughout the afternoon, musical entertainment, ranging from light jazz to country-western sounds, will be featured outdoors on the campus terrace (weather permitting) and refreshments served in the cafeteria.

A transportation pool has been arranged to provide rides to the campus from downtown Eugene. Rides will originate from the LCC Information Center at 878 Willamette St. every half-hour between 2-5 p.m.

SEE YOU AT THE OPEN HOUSE!



HIGHEST BIDDERS TO GET REPRODUCTIONS: Two reproductions of famous masters have been adapted as posters for the Sept. 28 election by TOM BLODGETT, art & applied design prof. and a student (name unknown at publication time).

One, Rembrandt's "The Bather," is displayed at the College Side Inn. The other reproduction, Eugene Delacroix's "Liberty Leading the People," can be seen at the Brass Rail.

The Open Door Committee is selling bid tickets (\$1) to persons interested in bidding to purchase one or both paintings after the election. Send sealed bids plus \$1 to Jim Ellison, Lyle Swetland, or Marston Morgan.

WATCH NIGHT PARTY: The Ladies of LCC invite all staff members to an election watch night party starting at 8 p.m. Tuesday in the Board Room.

Sherry Roof, wife of counselor Dave, is heading plans for the event.

***** REGISTRATION NOTES *****

AN ESTIMATED 4,700 students had registered for fall term by Thursday afternoon. The registration period has been extended Monday-Thursday of next week. Registrar Bob Marshall said this was done to allow students unable to get classes they need to consult a counselor again and seek alternate classes to complete their schedules.

THE ANNOUNCEMENT THAT EVENING CREDIT classes will begin next week was incorrect. The only classes starting next week are non-credit adult education, adult basic education, and high school completion. All credit classes begin the week of Oct. 4.

HOWARD'S THE ONE TO BEAT!

Twenty-three LCC golfers will tee off this afternoon in the first annual Washburn Landscaping Co. College Open Golf Tournament at the Emerald Valley Course in Creswell.

Vying for scoring honors, a host of prizes, and a chance to de-throne LCC's golf champ in the last couple of staff tournaments--JOHN HOWARD, Language Arts chairman, are:



JOHN LOUGHLIN, math
JORIS JOHNSON, adult ed.
DICK EYMANN, funding
BOB CREED, health & P.E.
DON OWNBEY, library
LARRY MURRAY, Special Training
MARK ROCCHIO, security
JIM BACON, lang. arts
EVAN ALFORD, lang. arts
KAY ANDERSON, lang. arts
DON WILSON, soc. sci.

JOHN JACOBS, science
CHUCK LAMB, data processing
WALT VANORDEN, college facilities
MARYANN MILLER
ROGER JAY, math
IRV ROTH, health & p.e.
BILL COX, college facilities
LYLE SWETLAND, development
NILE WILLIAMS, adult ed.
DICK "DIVOT" NEWELL, health & p.e.
ELDON SCHAFER, "the big driver"

MAGAZINES SOUGHT: The Business Dept. needs past issues of:
"Today's Secretary" "P.S. for Private Secretaries"
"The Secretary" "The Office"

or any other secretarial-oriented publications. Here's your chance to help out the students by cleaning your drawers and shelves and donating those old issues.

Bring them to Del Matheson in the library.

PART-TIME JOB: light housekeeping and child care on Tuesday and Thursday afternoons. Must have own transportation. Call 345-5844.

FOR SALE: 1971 model Honda 175 road bike. 3100 miles. \$450. Call Jerry Sirois, Ext. 315.

FOR SALE: 1963 Chevy Bel Air. Excellent Condition. \$345. Call 345-5844 evenings.

FOR SALE: German Shepherd puppies, show quality. Call 689-2265 or 688-4923.

STUDENTS AND STAFF: Volunteers are still needed for canvassing today. You can get block assignments at the LCC Information Center -- 343-5216.

EVENING HOURS: Starting Monday, the Bookstore will be open evenings from 6:30-8:30p.m. except Fridays. Fall term textbooks go on sale Wednesday.

EFFECTIVE THIS AFTERNOON, the south elevator in the library will be keyed from the second and third floors.

This means only persons with a key will be able to use this elevator for access to the fourth floor of the center building from the second the third floors.

ARE YOU FAMILIAR WITH ALL THE REFERENCE MATERIALS IN THE LRC? Tours of the Learning Resources Center are available upon request to librarian Del Matheson. Tours will be arranged to take only as much time as staff members can afford. Individuals as well as small groups are encouraged to take this tour at their convenience. Call Del at Ext. 211.

THE HOME ECONOMICS DEPT. regularly receives inquiries from LCC staff concerning the use of the Child Development Center. Existing policy limits child care in the Center to children of students. However, centers offering similar services are now operating in Eugene and Springfield. These centers presently have openings:

Springfield School District Center
1985 N. 19th St. (19th & Mohawk)
Phone: 747-3331, Ext. 357

Churchill High School Center
18th & Bailey Hill Road
Phone: 342-5611, Ext. 414



THE STORK HAS BEEN BUSY THIS WEEK...

ERIKA ROMINE (not a bad name) arrived Thursday morning. Our Information-Publications director says his 7 lb. 11 oz. daughter (the second for Larry and Molly) looks like her mother's side of the family.

WHEN CHERYL MATECKI, Language Arts secretary, started her maternity leave last Saturday, she was looking forward to a couple of week to herself before the baby's arrival date. BUT BABIES DON'T WAIT.

AARON MEDDIE MATECKI arrived Monday, weighing in at 7 lb. 3 oz.

Submit items for The Daily
to Erika Orchard, Ext. 224
or first floor Administration.

Monday

September 27, 1971

ELECTION EVE TELETHON: Residents of the LCC district will have an opportunity to "quiz the college" during an election eve telethon tonight on Teleprompter cable channel 12. College and community representatives will answer viewers questions about LCC and tomorrow's budget election from 5-6:30 p.m. and again at 8:30 p.m.

Questions will be accepted from 5-10 p.m. The number to call is 342-6524. The telethon is sponsored by the LCC Open Door Committee.

FALL TERM REGISTRATION has been extended through Thursday to accommodate students who have had trouble building class schedules because of the many section closures. Registration this week will be conducted from 8 a.m. - 5 p.m. in the Registrar's office.

Dean of Students Jack Carter said about 500 students are expected to take advantage of the additional four days of registration. About 4,700 students had registered for fall term as of Thursday. Many of them had to accept part-time student status because about 450 classes fill early and late registrants found slim pickings. Total fall term registration is expected at 1,550 FTE students.

CLASSES BEGINNING FOR SOME: Although the start of most credit classes has been delayed until Oct. 4, students in the Clerical Assessment program and those taking nursing subjects will begin classes this week. Also starting are adult education, adult basic education, and high school completion classes.

SECURITY TIGHTENED: Five exits from the library have either been locked or otherwise altered in an effort to reduce theft and create a better study atmosphere.

The library lost more books last year than in all its previous years of operation combined, according to librarian Del Matheson.

Library users now must exit via the circulation counter where books are checked out.

Matheson expressed optimism that the new arrangement also would eliminate the "shortcut" traffic through the second floor. He estimated that half of last year's traffic through this area was for purposes unrelated to the library.

Along with the new security checks, book stacks in the library have been rearranged to provide 50 additional study spaces.

A REMINDER: the south elevator in the library has been keyed from the second and third floors. Only key holders may use this elevator for access to the fourth floor.

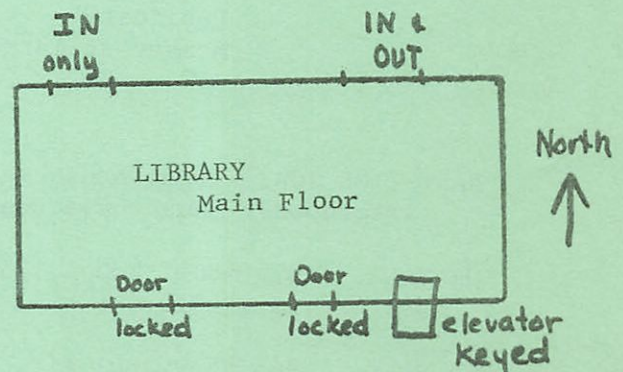

OPEN HOUSE SUCCESSFUL: Visitors numbering in the hundreds toured the LCC campus during yesterday's Open House. Not discouraged by intermittent showers, most took campus-wide tours guided by staff and students.

A jazz combo entertained in the cafeteria where refreshments were also served.

Among yesterday's visitors was former Sen. Wayne Morse who was shown the campus by Dr. Schafer.

Staff members were pleasantly surprised at the large turnout and found visitors "amazed" at the educational facilities.

TITANS TAKE OPENER: Titan depth paid off Saturday as LCC won its opening cross county meet of the season, taking the open division of the George Fox Invitational at Newburg.

Finishing ahead of Lewis & Clark and Mt. Hood, Lane runners were led by Bill Cramm who placed sixth. Six other Titans placed in the top 30 to provide the LCC margin of victory.

FRIDAY'S ALL-CAMPUS BREAKFAST drew 125 staff and students, Merlin Ames reports. The event was organized by the staff social committee.

WATCH NIGHT PARTY: The Ladies of LCC invite all staff members to join them at an election watch night party starting at 8 p.m. Tuesday in the Board room.

LADIES OF LCC OFFICERS for 1971-72 are:

PRESIDENT:	Alice Young
Vice-President	Jan Searl
Secretary	Priscilla Croft
Treasurer	Hilary Hodges
Membership	Mary Gramley
Publicity	Sherry Roof
Member at large	Lucy Schafer

PART-TIME JOB: light housekeeping and child care on Tuesday and Thursday afternoons. Must have own transportation. Call 345-5844.

FOR SALE: 1971 model Honda 175 road bike. 3,100 miles. \$450. Call Jerry Sirois, Ext. 315.

FOR SALE: 1963 Chevy Bel Air. Excellent condition. \$345. Call 345-5844 evenings.

FOR SALE: Hi Standard .22 cal semi-automatic pistol
Colt .45 cal. semi-automatic pistol
Colt .45 cal. revolver
Spanish Import 12 gauge double barrel shotgun
Mauser 8 mm rifle (partially sporterized)
Model 1903 Springfield 30,06 rifle

Contact Bob Boettcher, Ext 381 or 688-6575

OLD CHINESE PROVERB: If one word does
not succeed, ten thousand are of no avail.

English translation: VOTE!

Tuesday

September 28, 1971



IF YOU COULD COMPILE IT, the list of persons who actively backed the "LCC--KEEP IT TOGETHER" campaign organized by MARSTON MORGAN et. al. would S-T-R-E-T-C-H on and on.

HUNDREDS of students, faculty and staff, their wives, and many other friends of the college lent their time and talents and gave generously of their money to publicize today's election.

TO NAME
A FEW,
THANKS GO TO THE:

- * student canvassers
- * telephone callers
- * painting-fix-up crew and those who manned the Information Center
- * Open House hosts and tour guides
- * writers, artists, print shop people who prepared election information and designed posters
- * bake sale workers and contributors
- * election rally speakers
- * transportation pool volunteers

** radio and TV stations
which provided public
service time to announce
campaign activities

*** and to everyone who made a special
effort to encourage friends and
neighbors to support passage of today's
election.

THE ELECTION WATCH NIGHT PARTY begins at 8 p.m. in the Board room. Votes will be tabulated at the County Election Office and results phoned to the college as soon as they are available.

ALL STAFF are invited to await the results at the watch night party.

THAT'S A LOT OF COOKIES & CAKE: If you're ever in need of a sure money raising project and someone to head it, call JOLENE BOWERS. The energetic Special Training Programs Dept. secretary organized Saturday's Open Door Committee Bake Sale which by the end of the day had raise \$152.

THE BILLS ARE COMING IN: The Open Door Committee is still short on funds to pay the bills coming in from campaign activities. Donations may be sent to Lyle Swetland, Marston Morgan, or Jim Ellison. Make checks payable to Open Door Committee.

BID ON REPRODUCTIONS: Two reproductions of famous masters adapted as campaign posters by TOM BLODGETT and a student will be sold to the highest bidders. One, Rembrandt's "The Bather" is displayed at the College Side Inn. The other, Eugene Delacroix's "Liberty Leading the People" can be seen at the Brass Rail. The Open Door Committee is selling \$1 bid tickets to persons interested in purchasing one or both paintings. Send sealed bid plus \$1 to Marston Morgan.

STUDENT AWARENESS CENTER NEEDS SUPPLIES, EQUIPMENT

A Student Awareness Center, serving as a central information gathering and dissemination place, will begin operation next week under the auspices of Student Personnel Services.

Through the center, students will be able to get information about housing, child care, transportation, draft counseling, and legal aid referral. It will also serve as a message and information center. Minority relations and educational reform are among other student concerns the Center will deal with.

Co-directors of the student-conceived and operated Center are Earl Barrios and Mark Parrish. Parrish is presently serving as ASLCC publicity director but will resign that post to devote full time to his new position. The rest of the Awareness Center student staff has been picked and training sessions will be conducted this week. Supervisor is Betty Ekstrom, student activities director.

Parrish explained that although staff salaries will be paid through work-study funds, the Center has no operating budget. Therefore office supplies (paper, pencils, file folders), equipment and furniture must be acquired through donations.

Donations of supplies and materials or money for the purchase of equipment may be brought or sent to the Student Activities Office.

APPROVAL OF LCC'S PLAN for making up the week of classes lost by postponing the opening of Fall term has been received from the Oregon Board of Education.

Subject to Board approval:

- * The official fall term calendar will be extended to Dec. 22 (three additional days of class)
- * A fourth day will be made up by operating classes on Monday Oct. 25 (Veterans Day)

And one additional day will be made up at the discretion of individual department chairmen.

Classified staff and other twelve-month employees will make arrangements with their immediate supervisors regarding an alternate day off to take the place of Oct. 25.

In a memorandum to administrators and department chairmen, Dr. Schafer said that all classes will continue to meet on their regular meeting days until Dec. 22. Final examinations are to be scheduled during the regular time allotted to class meetings. In those classes not having final examinations, it will be assumed that students will meet with their instructors for end-of-term conferences and evaluations, he said.

THE COLLEGE CABINET will meet at 3 p.m. today in the Board room.

Wednesday

A 23 percent turnout of district voters (the largest this year) led to the 3-2 victory, the same margin by which the Aug. 26 budget request was defeated.

And for the first time this year, the budget was approved in Eugene, Springfield, Oakridge, Pleasant Hill, Cottage Grove, Florence, and Blue River. The levy lost at only 4 of 14 Springfield polling places and 2 of 29 in Eugene (Malabon School 119-123; Fire Station, 900 McKinley 130-141).

LOOKING BACK ON THE ELECTIONS THIS YEAR

	<u>APRIL 13</u>		<u>JUNE 29</u>		<u>AUG. 26</u>		<u>SEPT. 28</u>		
	<u>YES</u>	<u>NO</u>	<u>YES</u>	<u>NO</u>	<u>YES</u>	<u>NO</u>	<u>YES</u>	<u>NO</u>	
EUGENE	3702	5762	5730	5794	4265	5433	8917	4492	**
SPRINGFIELD	1019	2219	1092	1966	1502	2906	2418	1962	**
COTTAGE GROVE	338	718	253	487	653	899	637	513	**
JUNCTION CITY	195	339	183	256	242	580	469	491	
FLORENCE	202	214	109	170	197	365	272	259	**
FERN RIDGE	81	290	65	260	130	441	262	351	
CRESWELL	95	234	85	195	143	377	242	279	
PLEASANT HILL	142	288	121	195	150	219	279	205	**
OAKRIDGE	114	246	102	177	158	240	236	223	**
HARRISBURG	48	51	41	26	43	14	90	42	**
MONROE	21	30	9	12	13	11	31	23	**
MAPLETON	62	91	59	63	59	148	95	108	
McKENZIE	40	137	41	84	35	96	73	65	**
LOWELL	32	81	31	60	75	216	121	169	
MARCOLA	31	64	20	38	51	153	100	120	
BLACHLY	25	63	14	40	18	72	44	48	
TOTALS: (include several precincts not listed above)	5913	11,592	8,295	10,488	7,783	12,346	14,438	9,633	



PEOPLE IN THE NEWS

COUNSELOR JAN BRANDSTROM has been selected faculty representative to the Instructional Council for fall term. Named to represent the Instructional Council at College Cabinet meetings was MEL GASKILL, Mechanics Dept. chairman.

HERB PRUETT, Mechanics prof is president-elect of the Oregon Vocational Association.

THE DESIGN of the latest issue of "Old Oregon," University of Oregon's alumni magazine is the talent of DON JOHNSON, printing/graphics specialist.

CO-CHAIRMEN of the OCCA Classified Workshop set for Nov. 6 at Lane are JUDY PIERCY, scheduling-curriculum clerk, and MARTIN McMASTER, college facilities.

DON WILSON, social science prof and LCC tennis coach proved he knows how to handle a driver and putter as well as a tennis racket by taking top honors in two categories at Friday's Washburn Open Golf Tournament. Don won the low gross (actual score) title, tallying an 83 over Creswell's Emerald Valley course. He also came closest to the pin on the back nine holes. Evan "Easy" Alford took the low net (actual score less handicap) championship, besting staff members by shooting a 72.

Other winners were ROGER JAY, math prof, who had the longest drive on the back nine, and BOB CREED, wrestling coach, who had the longest drive on the front nine and came closest to the pin, also on the front nine. Runnerups in the gross and net divisions respectively were former "champ" JOHN HOWARD, Language Arts chairman (84) and LARRY MURRAY, Special Training Programs director (73½)

RESULTS:

	<u>GROSS</u>	<u>NET</u>		<u>GROSS</u>	<u>NET</u>
EVAN ALFORD	106	72	ROGER JAY	93	76
LARRY MURRAY	101	73½	DON OWNBEY	101	76½
IRV ROTH	88	74	DOUG WASHBURN	113	76½
DON WILSON	83	74	WALT VANORDEN	98	77
BOB CREED	89	74	JIM BACON	97	77
DIVOTS NEWELL	94	75	NILE WILLIAMS	94	77
JOHN HOWARD	84	75	KAY ANDERSON	119	77
LYLE SWETLAND	102	75½	BILL COX	102	77½
JOHN LOUGHLIN	104	75½	JOHN JACOBS	104	77½
JORIS JOHNSON	109	76	MARK ROCCHIO	94	78
			AL TARPENNING	113	79½
			OMAR BARBAROSSA	115	79½
			DICK EYMANN	128	85

PLAYED 9 HOLES ONLY:

ELDON SCHAFER 49 - 78
MARYANN MILLER 62 - 74

LCC LANDSCAPER GARY WASHBURN will be working this week at Emerald Valley repairing the turf divoted by Newell.

Submit items for The Daily
to Erika Orchard, Ext. 224
or first floor, Administration.

Thursday

September 30, 1971

A NUMBER OF CLASS SECTIONS have been opened as a result of Tuesday's successful budget election. Registrations will be accepted today from 8 a.m. - 5 p.m. and Monday through Thursday of next week (8a.m.-8p.m). No late fee will be charged students registering next week.

The following classes and programs, listed in alphabetical order by department, have been opened and are now accepting registrations:

Art & Applied Design -- Painting; Basic Design
Business Dept -- openings in most programs
Data Processing -- first year classes open
Health & P.E. -- general classes open
Home Economics -- Nutrition; Child Development
Industrial Technology -- Drafting; Architectural Drafting; Welding
Language Arts -- English Composition; Literature
Mass Communications -- Speech; Photography
Mathematics -- Engineering Problems; Elementary Algebra; Introduction to Algebra
Mechanics & Transportation -- Auto Diesel I; Second-Year Automotive; Aviation Maintenance and Powerplant; Agricultural & Industrial Technology
Performing Arts -- some general classes
Science -- Chemistry
Social Science -- Afro-American History; Survey of U.S. History; Western Civilization; Geography; American Government; Psychology; Sociology

HEALTH INSURANCE AGENT Archie Zarewski will be available in the business manager's office FRIDAY at 9:30 a.m. to answer insurance questions.

EVALUATION INFORMATION: A folder containing background readings on evaluation is now on reserve in the library. Most of the material in this folder was distributed by the Faculty Section Evaluation Committee last spring, but some additional items are included.

The Faculty Section's recommended evaluation procedure, based partly on these readings, has been received by the Instructional Council. Discussion of the recommendation will continue at the Oct. 7 Council meeting. NOTE: The ERIC Research Reviews are available on microfiche through Don Ownbey.

STAFF ASSOCIATION DUES: Staff members wishing to pay Staff Association dues through a payroll deduction in October are reminded to submit their payroll deduction authorization forms by Friday, Oct. 8. Forms should be sent the respective sections through these persons:
Faculty -- Paul Patrick or Jim Evans
Classified -- Judy Piercy
Administration -- Betty Kepner
Dues payments by cash or check should also be made to these individuals.

COMMUNITY COLLEGES GROWING: More than 63,000 students are expected to enroll in Oregon's 13 community colleges this fall. This is an increase of about 7,000 over the record enrollment one year ago.

TUITION RATES APPROVED: The State Board of Education yesterday formally approved the tuition rates for 1971-72 established by the state's community college district boards. In-district tuition ranges from \$80 at LCC to \$105 at Blue Mountain Community College. Tuition increases range from no change at five community colleges to a \$10 increase at five others and a \$12 increase at Linn-Benton.

COUNSELOR PAT FRALEIGH and his wife SUSAN are the parents of a 7 lb. 3 oz. daughter. Margaret Susan was born Sept. 26.

FOR SALE: 1970 Hornet SST. 4-door with V-8 engine; Automatic transmission, power steering, two-tone paint. Contact Herb Pruett, Automotive Dept.

FOR SALE: 12-gauge double barrel shot gun plus boxes of shells. \$140.
- Mauser 8mm rifle. \$60
- 30,06 Springfield rifle. \$60
Contact Bob Boettcher, Science, Ext. 381.

SHARE A RIDE: A UO student would like to share ride and expenses. Commutes from Salem to Eugene Mondays and Fridays. Call Linda at 313-7124.



"Just look at this report card! 'Accommodates enrichment data, inputs easily, and is generally self-programming.'"

Donald Miller